

# A/C UNIT DISASSEMBLY/ASSEMBLY [FULL-AUTO AIR CONDITIONER]

---

B3E071161130W02

1. Disassemble in the order indicated in the table.

## Caution

- If a non-specified grease is used, it may result in abnormal noise or improper operation of the links. Apply only the specified grease to each link.

2. Assemble in the reverse order of disassembly.

**L.H.D.**

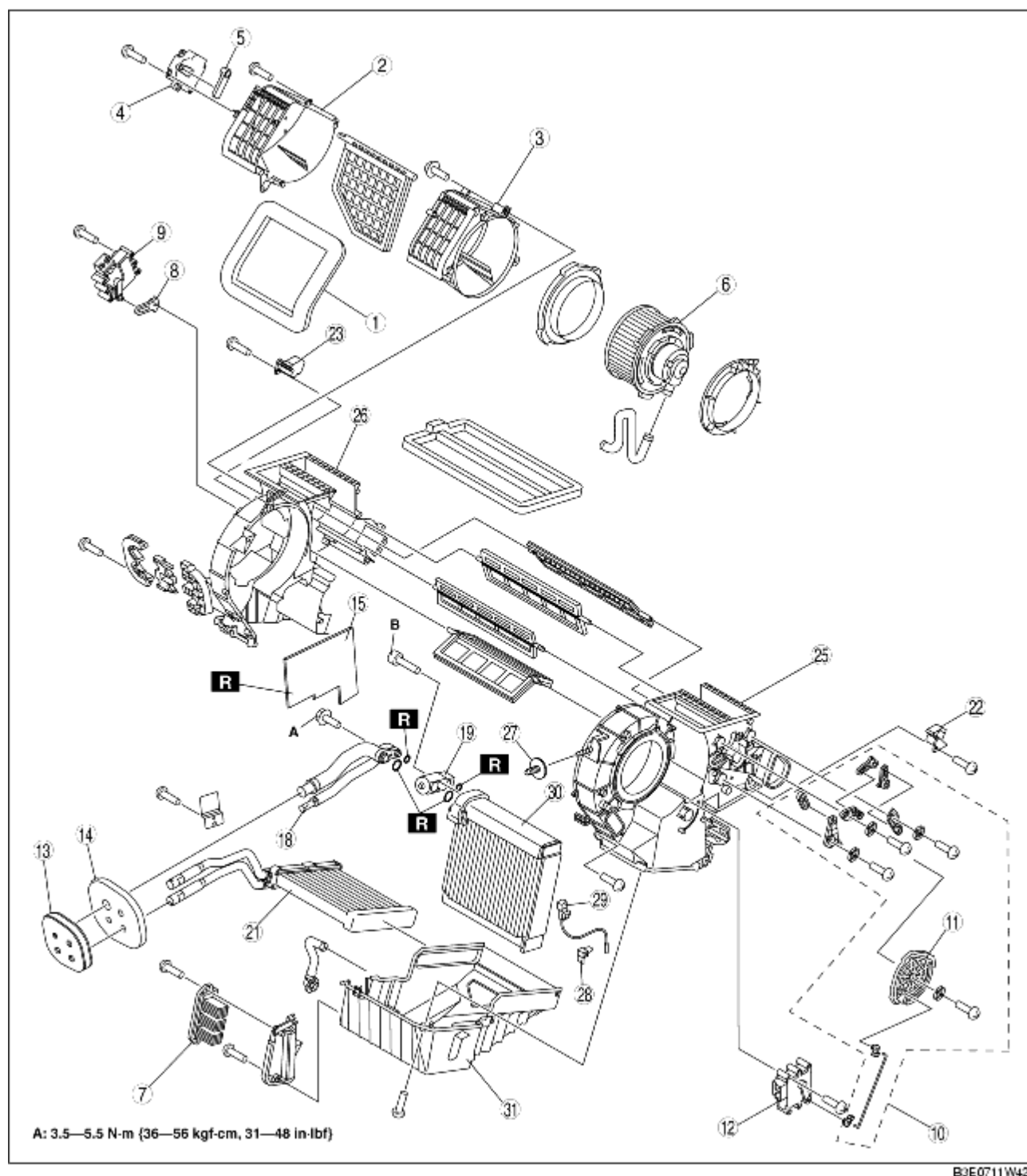

R.H.D.

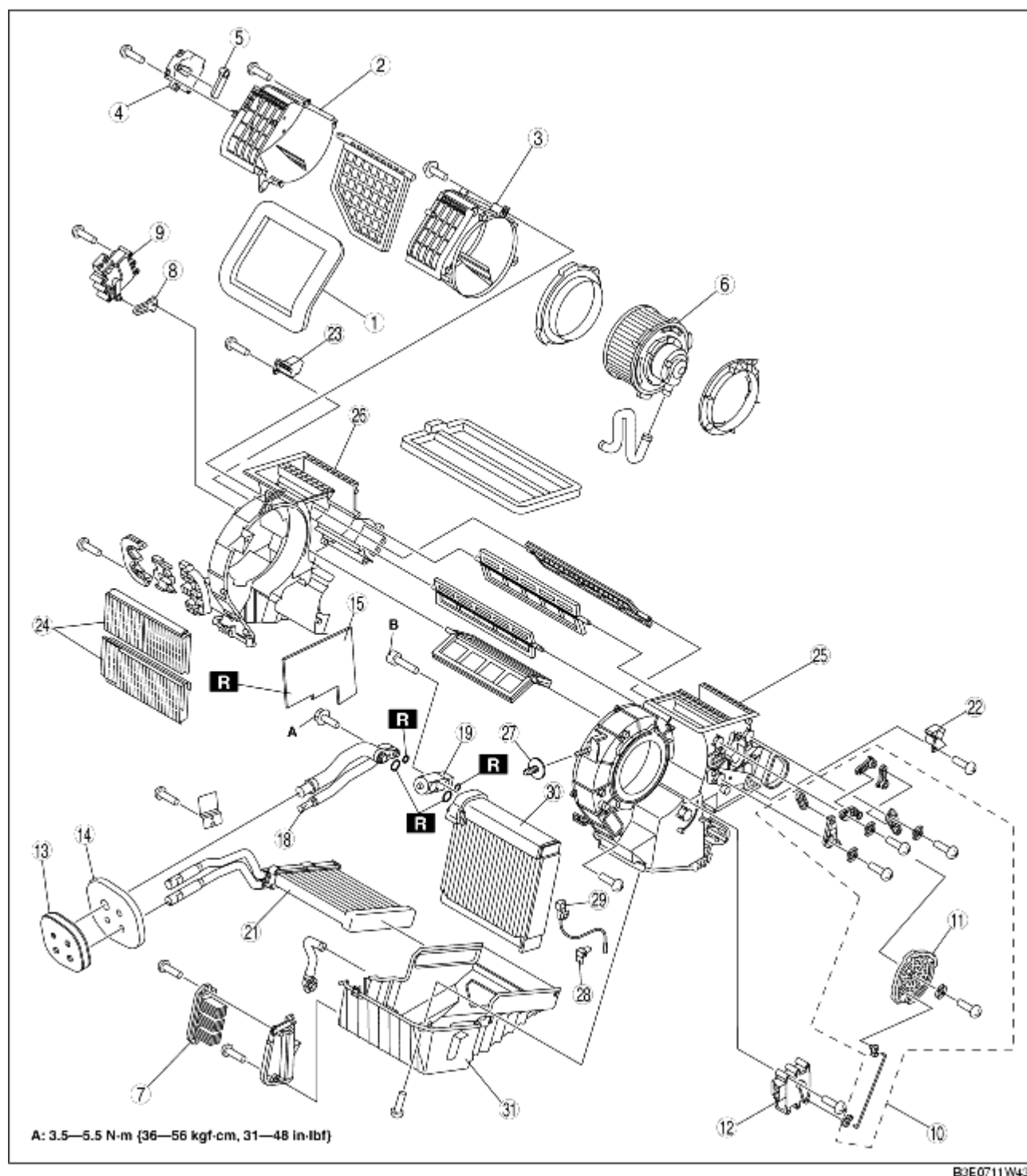

1	Adhesive polyurethane (1)
2	Blower case (1)
3	Blower case (2)
4	Air intake actuator
5	Air intake link set
6	Blower motor (See <a href="#">BLOWER MOTOR REMOVAL.</a> ) (See <a href="#">BLOWER MOTOR INSTALLATION.</a> )
7	Power MOS FET

8	Air mix link set
9	Air mix actuator
10	Airflow mode link set
11	Airflow mode main link
12	Airflow mode actuator
13	Polyurethane foam
14	Adhesive polyurethane (2)
15	Adhesive polyurethane (3)
16	Adhesive polyurethane (4) (R.H.D.)
17	Adhesive polyurethane (5) (R.H.D.)
18	Evaporator pipe
19	Expansion valve
20	Adhesive polyurethane (6) (R.H.D.)
21	Heater core
22	Bracket (1)
23	Bracket (2)
24	Air filter
25	A/C case (1)
26	A/C case (2)
27	Bolt (See <a href="#">Bolt Assembly Note.</a> )
28	Sensor clamp (See <a href="#">Sensor Clamp Assembly Note.</a> )
29	Evaporator temperature sensor (See <a href="#">Evaporator Temperature Sensor Assembly Note.</a> )
30	Evaporator
31	A/C case (3)

## Evaporator Temperature Sensor Assembly Note

1. Assemble the evaporator temperature sensor as shown in the figure.

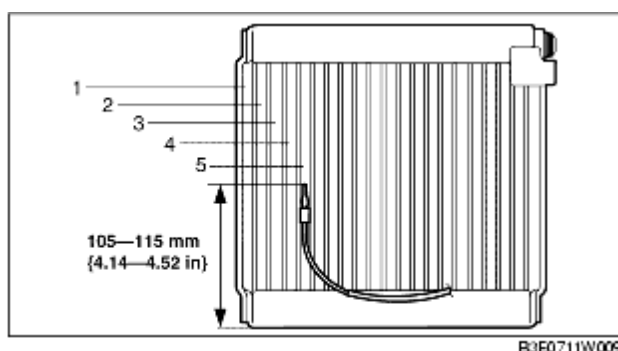

## Sensor Clamp Assembly Note

1. Attach the sensor clamp as shown in the figure.

## Bolt Assembly Note

1. Tighten it to the right so that it is flush to the contact surface.

